

### G80

#### Universal bracket with recess flushing cisterns' support for wall hung wc

##### APPLICATION

Used to **fasten recess flushing cisterns** and provided with support bracket for wall hung wc, on walls 80 mm thick.

##### FEATURES AND BENEFITS

- > Robust and preassembled, it is particularly suitable for a fast and reliable installation of **wall hung wc with recess cistern**.
- > **Universal**: it fits any kind of recess cistern about 70-80mm thick.
- > **Adaptable** to centre-to-centre distance between 180mm and 230mm, it can be adjusted even when the wall has been completed.
- > Designed to fit the dimensions established by the UNI EN 38 regulation.
- > Provided with special hook to fix drainpipes of 90mm and 110mm diameter.
- > Every package is completed with **installation instruction**.
- > Please note that the structure does not stand on its own.

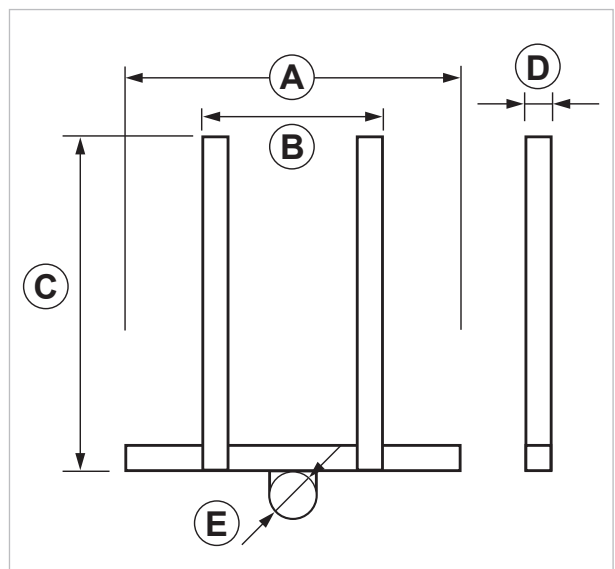
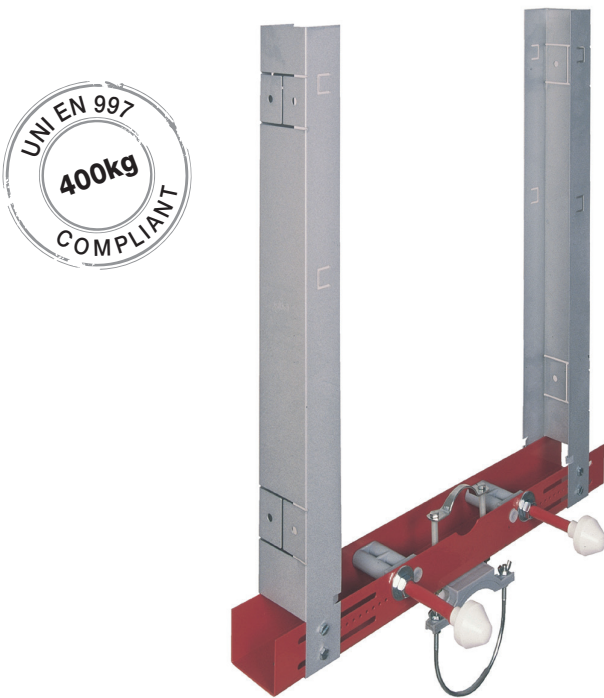
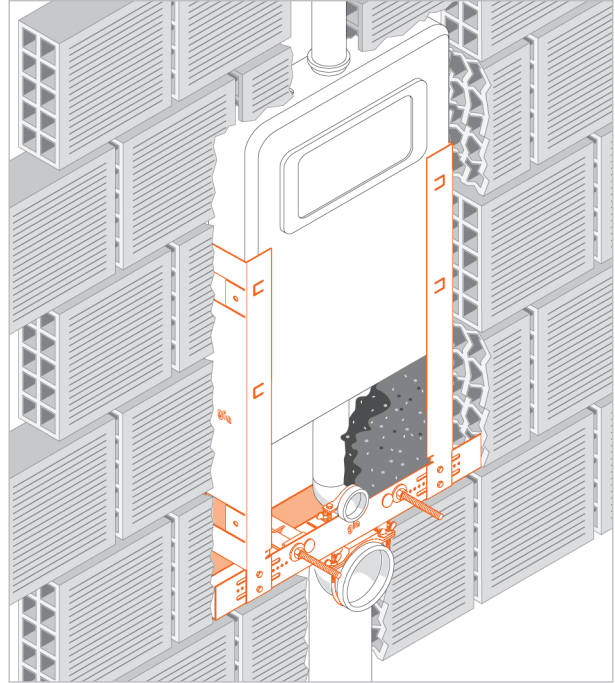

COD	TYPE	A	B	C	D	E
020600	G80	585	365	660	82	90-110

# WALL HUNG WC AND BIDET FASTENING

## SANITARY FIXINGS

Composed of:

- red and grey painted steel structure
- special pipe clamp for drainpipe
- white nylon caps and washers
- zinc plated washers and nuts for wc fixing
- M12 support rods with nuts and washers for installation

### MATERIALS TECHNICAL DATA

#### BRACKET

Painted steel DD11 EN 10111

#### COMPONENTS

Steel 4.8 EN ISO 898.1 with electro zinc plating 7-8 µm

#### WASHERS

White Nylon PA6

#### CAPS

PE Polyethylene

### PACKAGING

In cardboard box | 1 item per box

### RELATED ITEMS

> CAP - Fixing kit

#### DATE 07-2022 REV. 01

The current technical data sheet substitutes and nullifies the previous ones. Information correspond with our current knowledge of the product. It cannot lead us to any sort of responsibility or compensation.

Gia S.p.A. reserves the right of changing technical features and molds without previous notice.

Company under the management of "Ethica Global Investments S.p.A."

Gia S.p.A. – Via Sac. A. Cremona, 12 – 28069 Trecate (NO) – [www.gia.it](http://www.gia.it)