

PN 300 - PN 600 G-Strut angle strengthening support

APPLICATION

Seismic lateral support. Used as vertical strengthening support for PAP G-Strut brackets.

FEATURES AND BENEFITS

- > Thanks to its specific shape it can be directly fixed to PAP G-Strut brackets - using the JBR 10 quick connect bolt (cod. 161950) - in order to **create lateral seismic support wind-braces**.
- > By turning the support vertically it is possible to create a **support bracket** for PAP G-Strut brackets.

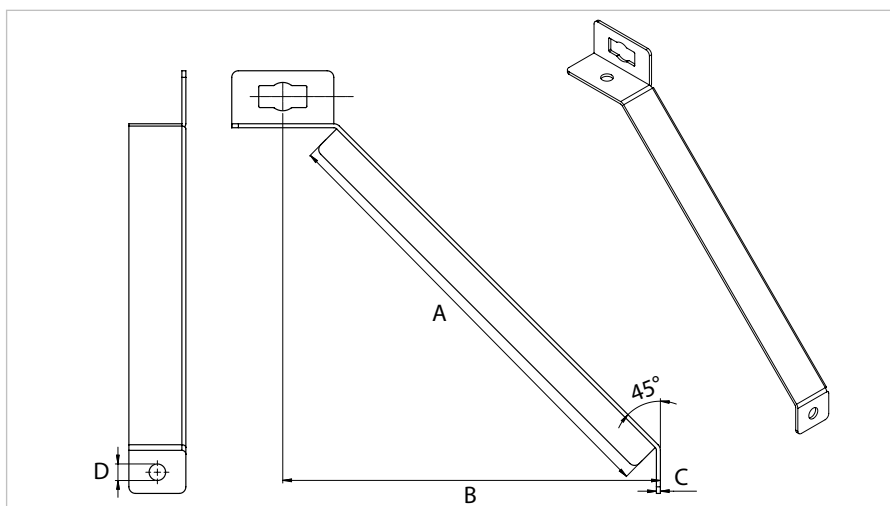

COD	TYPE	Description	A	B	C	D
161060	PN 300	300 mm Long	330	285	3	Ø 12,5
161062	PN 600	600 mm Long	734,4	585	3	Ø 12,5

INDUSTRIAL FIXING SYSTEMS

SUPPORT BRACKETS

MATERIALS TECHNICAL DATA

SUPPORT

Steel DD11 EN 10111 with sendzimir zinc plating

RECOMMENDED LOADS FOR LATERAL SUPPORT

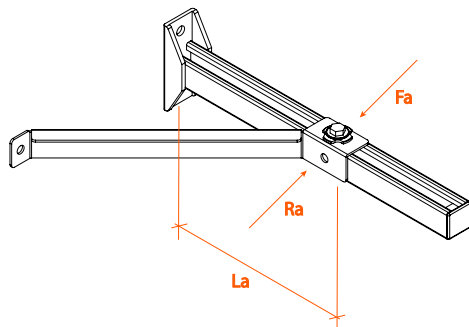

TYPE	Load capacity bracket + support	Distance from applied load
PN 300	370 daN	300 mm
PN 600	500 daN	600 mm

Static capacity loads

F_a = Horizontal seismic force (in daN)

R_a = Horizontal resistant force (in daN)

L_a = Distance from applied load (in mm)

RECOMMENDED LOADS FOR LATERAL SUPPORT

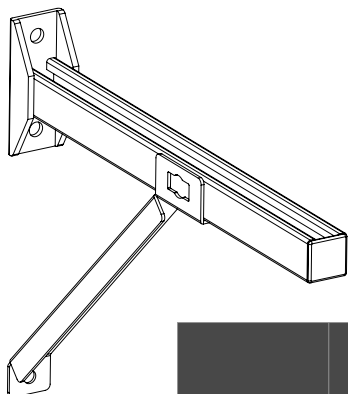

F = concentrated load in daN.

Q = evenly distributed load in daN.

For wall fastening please consider the supporting performance of the plug or the connection piece.

TYPE	SUPPORT	F_1 = daN	F_1 = daN	F_2 = daN	Q = daN
PAP 40	PN 300	550	240	240	500
PAP 50	PN 300	500	200	200	450
PAP 75	PN 600	350	150	150	300
PAP 100	PN 600	220	50	100	200

PACKAGING

In cardboard box

RELATED ITEMS

> G-Strut and Seismic-strut industrial fixing

DATE 06-2023 REV. 01

The current technical data sheet substitutes and cancels the previous ones. The details provided fit our current knowledge of the product. It cannot lead us to any sort of responsibility or compensation.

Gia S.p.A. reserves the right of changing technical features and molds without notice.

This company is subject to "Ethica Global Investments S.p.A." management.

Gia S.p.A. – Via Sac. A. Cremona, 12 – 28069 Trecate (NO) – www.gia.it