

TRI Angle support bracket

APPLICATION

Used to connect pipe clamps to **PF / PF1 / PF7 / PF2 strut channels**.

Used to fasten pipe lines and other components or to reinforce heavy duty installations.

FEATURES AND BENEFITS

- > Used for **PF/PF1/PF7/PF2 strut channels** and to create 45° or 90° connections.
- > Used to reinforce **PA30/PA40/SAT/SAT1/SAT2 brackets** and to contrast side thrusts.
- > It is necessary when roll supports and sliding glides are used.

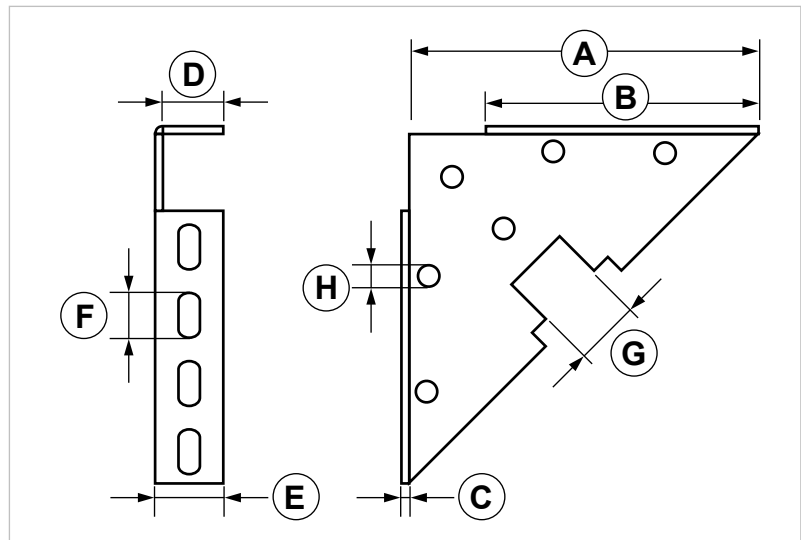
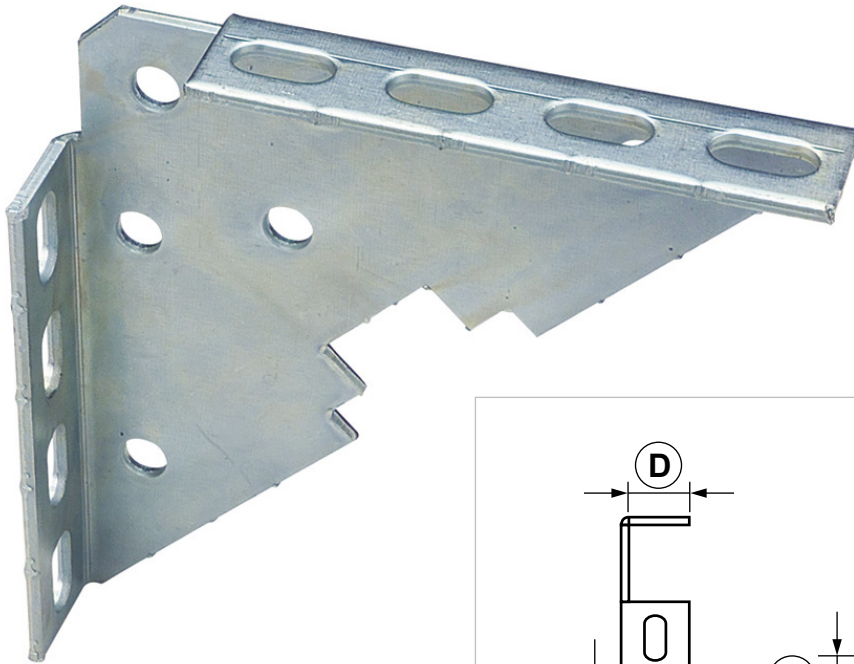
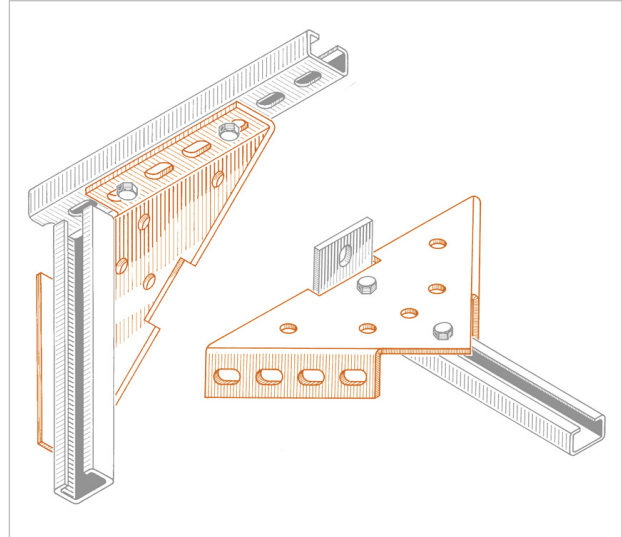

COD	TYPE	A	B	C	D	E	F	G	H
161300	TRI	183	140	4	31	35	11 x 23	35	11

GRIP LIGHT DUTY FIXING SYSTEM

ANGLE BRACKETS AND CONNECTION PLATES

MATERIALS TECHNICAL DATA

BRACKET

Steel DD11 EN 10111 with electro zinc plating 7-8 µm

RECOMMENDED LOADS

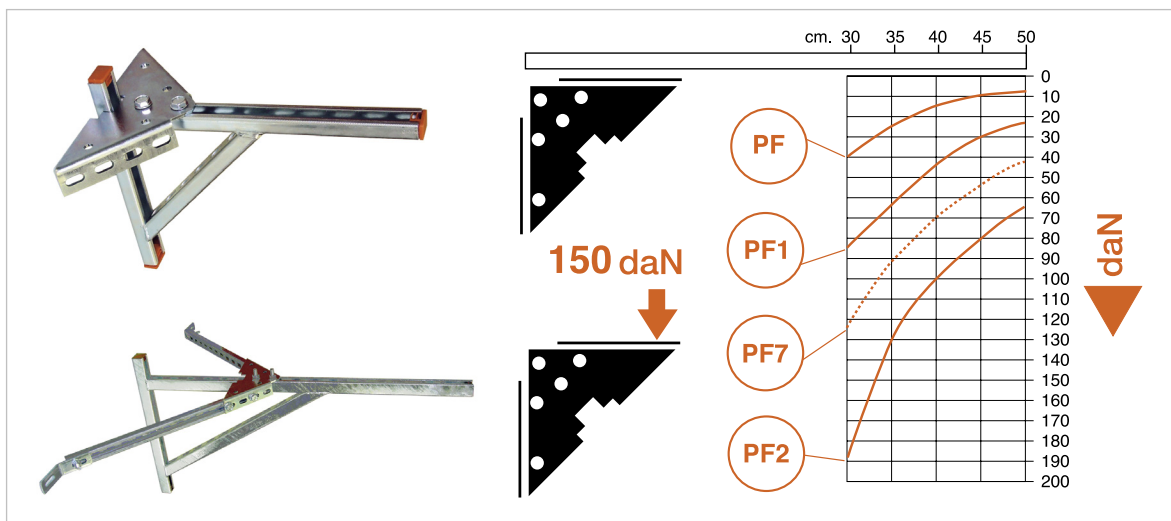

F = Concentrated load in daN

Q = evenly distributed load in daN

Safety load = 140 N/mm² (14 Kg./mm²)

Admissible deflection = L/125

Safety coefficient = ½ sliding value.

For wall fastening please consider the supporting performance of the plug or the connection piece.

PACKAGING

In cardboard box

RELATED ITEMS

- > Strut channels
- > Connection parts

DATE 06-2023 REV. 01

The current technical data sheet substitutes and cancels the previous ones. The details provided fit our current knowledge of the product. It cannot lead us to any sort of responsibility or compensation.

Gia S.p.A. reserves the right of changing technical features and molds without notice.

This company is subject to "Ethica Global Investments S.p.A." management.

Gia S.p.A. – Via Sac. A. Cremona, 12 – 28069 Trecate (NO) – www.gia.it