

TDU

Universal support frame for plasterboard walls

APPLICATION

Used to fasten various kind of items on drywalls.

FEATURES AND BENEFITS

- > **Preassembled support frame** for a fast installation. It is made of zinc plated steel -compliant with EN10143 and EN10346 regulations - and multilayered wood, 20 mm thick - compliant with EN13986 regulation.
- > **Suitable** to support **wall hung payloads**: wall hung items, such as accessible handles, kitchen cabinets, handrails for stairs and corridors, shelves, supports for wall hung electrical appliances and electronic systems,etc.
- > **It can be adjusted during installation** and it is provided with a multilayered wood panel - which has to stick to the wall - and complete with lateral fixing flanges.

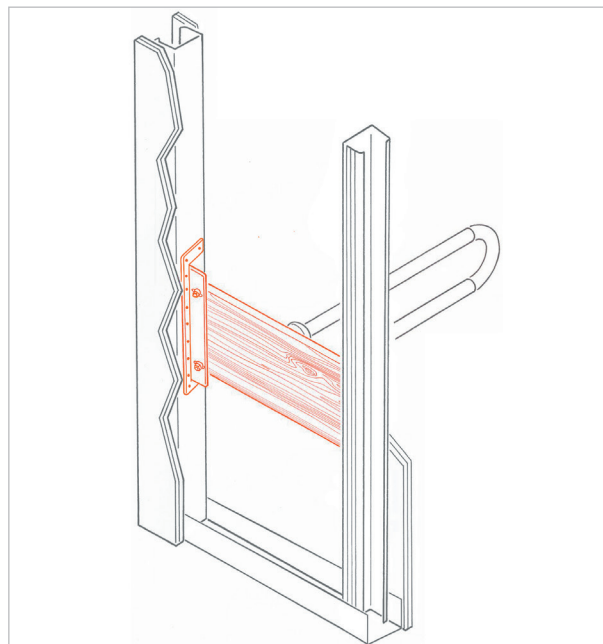

Composed of:

- 1 multilayered wood panel, 20 mm thick
- 2 preassemble steel struts to fix the item to the wall's pillars
- 4 fixing screws

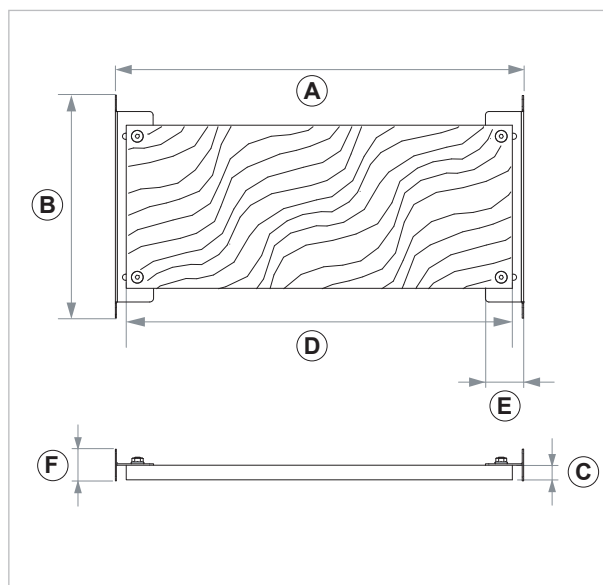

COD	TIPO	A	B	C	D	E	F
020733	TDU	530/550	300	20	520	51,5	41,5

SANITARY FIXINGS FOR PLASTERBOARD WALLS

SANITARY FIXINGS

MATERIALS TECHNICAL DATA

FRAME

Zinc plated steel DX51D+Z100 MAC - EN 10143, EN 10346

COMPONENTS

Steel 4.8 EN ISO 898.1 with electro zinc plating 7-8 μm

WOOD PANEL

Multilayered wood 520x220x20mm

BASE MATERIAL

Plasterboard

RECOMMENDED LOADS

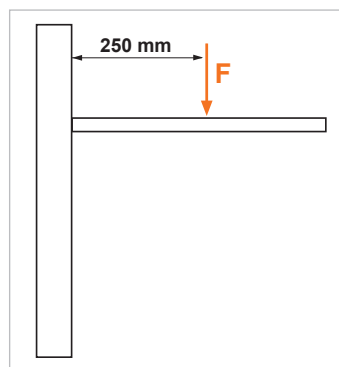

TYPE	F
TDU	200

F = payload measured in daN

Recommended load is the average resistance load with a safety coefficient.
1daN=1kg

INSTALLATION

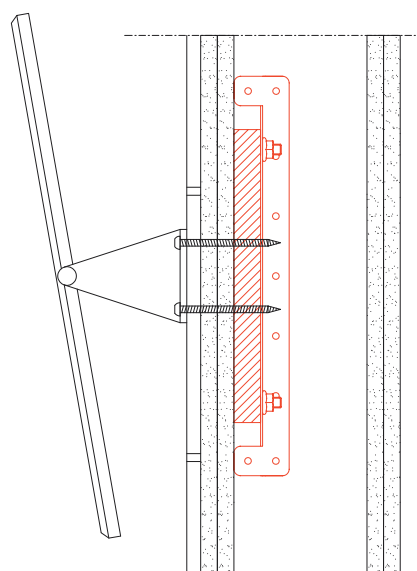

PACKAGING

In cardboard box

RELATED ITEMS

> Plasterboard product range

DATE 10-2022 REV. 02

The current technical data sheet substitutes and nullifies the previous ones. Information correspond with our current knowledge of the product. It cannot lead us to any sort of responsibility or compensation. Gia S.p.A. reserves the right of changing technical features and molds without previous notice. Company under the management of "Ethica Global Investments S.p.A."

Gia S.p.A. – Via Sac. A. Cremona, 12 – 28069 Trecate (NO) – www.gia.it