

TDSRA - TDIRA

Z-shaped brackets for plasterboard walls

APPLICATION

It is used to fasten additional pipelines.

FEATURES AND BENEFITS

- > **Preassembled item** that can be installed on a pre-existing frame.
- > Particularly useful to fasten **additional accessories** in sanitary fixtures.
(“TDIRA” version only for internal applications)
- > Complete with **antirotation brass socket** G1/2” M/F.

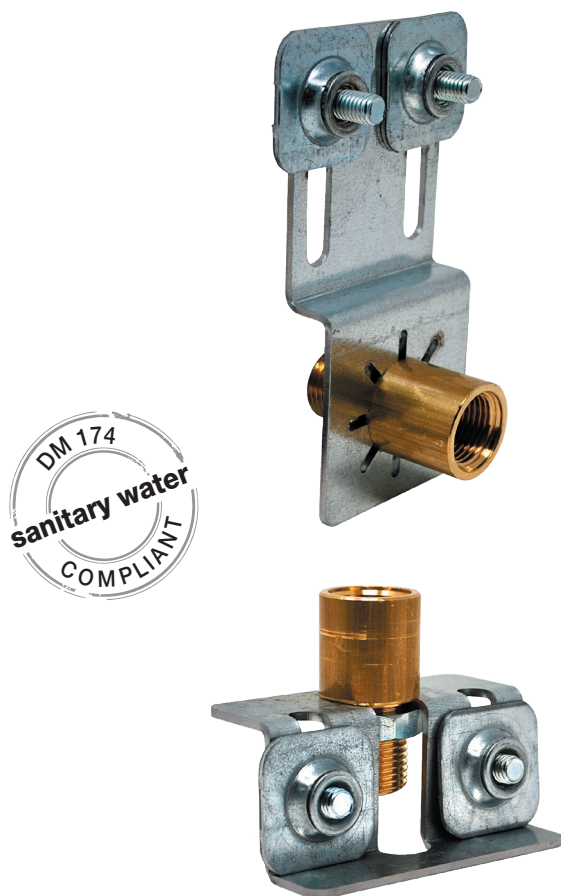
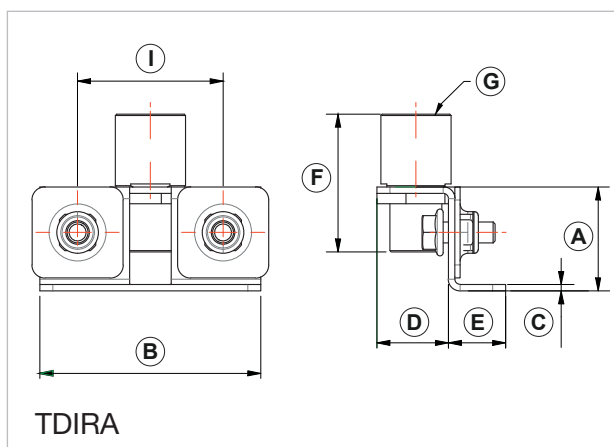
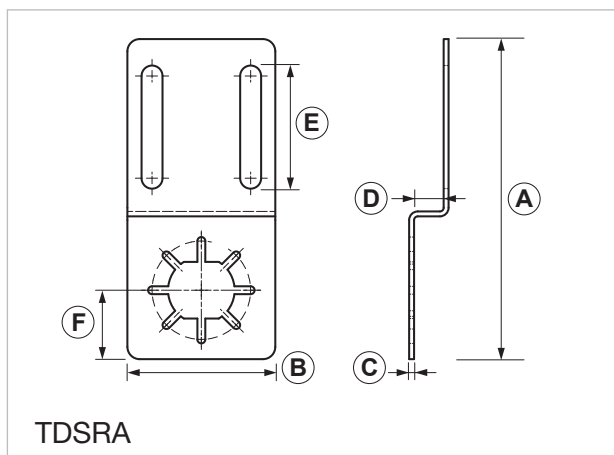
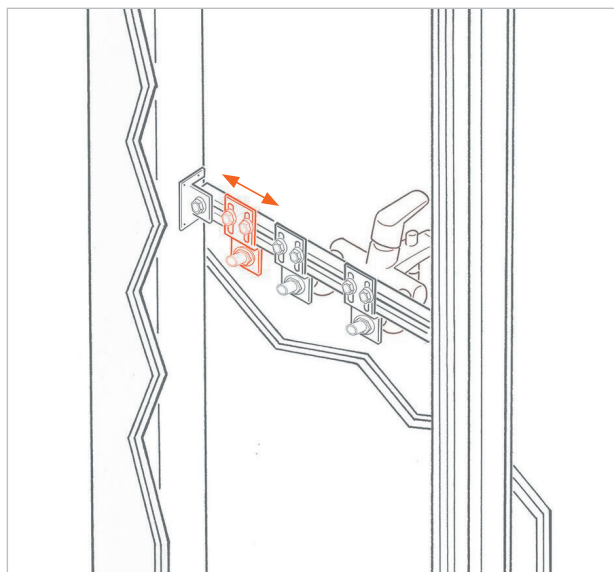

COD	TIPO	A	B	C	D	E	F	G	I
020739	TDSRA	130	60	2	12	50	28	-	-
020732	TDIRA	40	85	2,5	27,5	22	53	G 1/2	56

SANITARY FIXINGS FOR PLASTERBOARD WALLS

SANITARY FIXINGS

MATERIALS TECHNICAL DATA

PLATE

Zinc plated steel EN 10143, EN 10346

SOCKET

Brass CW 614N EN 12164

COMPONENTS

Steel 4.8 EN ISO 898.1 with electro zinc plating 7-8 µm

BASE MATERIAL

Plasterboard

PACKAGING

In cardboard box

RELATED ITEMS

- > TDM1 - Internal mixer bracket frame for plasterboard walls
- > TDM2 - External mixer bracket frame for plasterboard walls
- > TDLA - Dishwasher / washing machine bracket frame for plasterboard walls
- > TDT - Universal crossbeam for plasterboard walls

DATE 10-2022 REV. 02

The current technical data sheet substitutes and nullifies the previous ones. Information correspond with our current knowledge of the product. It cannot lead us to any sort of responsibility or compensation.

Gia S.p.A. reserves the right of changing technical features and molds without previous notice.

Company under the management of "Ethica Global Investments S.p.A."

Gia S.p.A. – Via Sac. A. Cremona, 12 – 28069 Trecate (NO) – www.gia.it