

HEAVY DUTY PIPE CLAMPS FOR PE PIPE LINES

PIPE CLAMPS AND PIPE LINES FIXINGS

STP1

Heavy duty pipe clamp with G 1" connection

APPLICATION

Suitable for PE pipe lines with large diameters and all other kinds of pipe lines.

FEATURES AND BENEFITS

- > Thanks to the thickness of the steel it is made of, and the **continuous wire welded nut - 1/2" F BSP** - this pipe clamp is extremely solid.

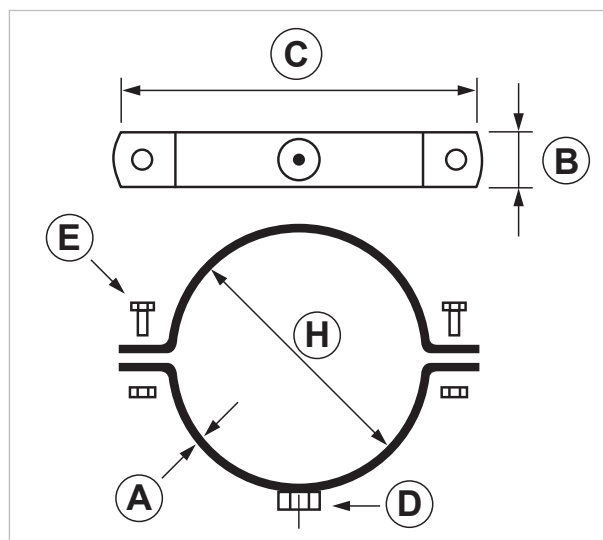
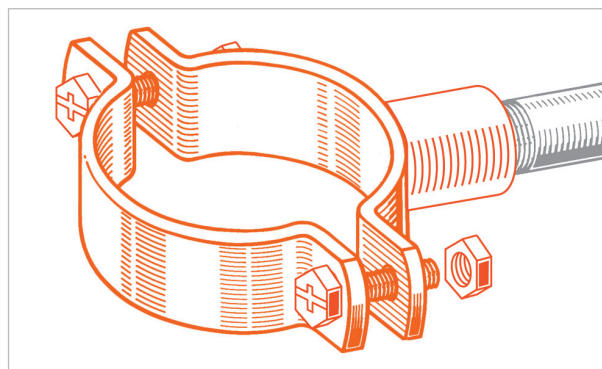

COD	TYPE	A	B	C	D	E	H
085801	STP1 200	4	40	283	1"	M8x35	200
085821	STP1 220	4	40	306	1"	M8x35	220
085851	STP1 250	4	40	336	1"	M8x35	250
085901	STP1 315	4	40	400	1"	M8x35	315
085951	STP1 400	4	40	501	1"	M8x35	400

HEAVY DUTY PIPE CLAMPS FOR PE PIPE LINES

PIPE CLAMPS AND PIPE LINES FIXINGS

MATERIALS TECHNICAL DATA

PIPE CLAMP

Steel DD11 (material. N. 1.0332) DIN EN 10111 - with electro zinc-plating 7-8 µm

LOCKING SCREW

Steel 4.8 EN ISO 898.1 with electro zinc-plating 7-8 µm

M6x20 - Hex head combined shear screw

M8x35 - Hex head flat shear screw

SPACERS (when used)

PE Polyethylene

RECOMMENDED LOADS

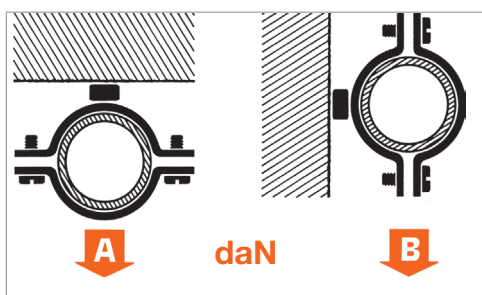

Tests were carried out in technical laboratory with a dynamo-metric machine. For wall fixing, stick to the strength characteristics of the plug or the connecting support.

TYPE	A	B
STP - STP1 40	300	150
STP - STP1 50	300	150
STP - STP1 63	300	150
STP - STP1 75	300	150
STP - STP1 90	300	100
STP - STP1 110	300	100
STP - STP1 125	300	80

TYPE	A	B
STP - STP1 140	300	60
STP - STP1 160	300	40
STP - STP1 200	400	100
STP1 220	400	90
STP - STP1 250	400	70
STP - STP1 315	400	70
STP - STP1 400	400	40

Recommended load is the average resistance loads with a safety coefficient. Data are expressed in daN. 1 daN=1 kg.

INSTALLATION TOOLS AND RECOMMENDATIONS

In order to properly install the plug, make a hole perpendicularly to the base support using the right drill bit.

Before installing the plug make sure the hole is clean and all the drilling dust has been removed.

We recommend not to use an impact drill while making the hole on an hollow brick wall in order to prevent the internal bulkheads break. Eventually, fasten both nut and pipe clamp.

PACKAGING

In polyethylene bag - from STP1 40 to 160

In cardboard box - from STP1 200 to 400

RELATED ITEMS

- > NP-NP1 - PVC tapes
- > PP-PP1 - Pipe clamps fixing plate
- > COP - Universal metal covering
- > Reduction socket
- > Adapters

DATA 09-2022 REV. 01

The current technical data sheet substitutes and cancels the previous ones. The details provided fit our current knowledge of the product. It cannot lead us to any sort of responsibility or compensation.

Gia S.p.A. reserves the right of changing technical features and molds without notice.

This company is subject to "Ethica Global Investments S.p.A." management.

Gia S.p.A. – Via Sac. A. Cremona, 12 – 28069 Trecate (NO) – www.gia.it