

### SI Insulated hinged pipe clamp with EPDM sheath for drainage pipes

#### APPLICATION

Used to fasten insulated drainage pipe lines.

#### FEATURES AND BENEFITS

- > The patented "S" shape of the coupling piece allows an **easy and reliable** execution of either **fixed or sliding points**.
- > The **clip-on system** speeds up the pipe clamp fastening: you just have to tighten the pre-mounted screw as required.
- > The special electro-welded adapter ensures **1/2" male and M10 female double hooking**.
- > The EPDM rubber ensures **acoustic insulation uniformity** on the whole pipe circumference.

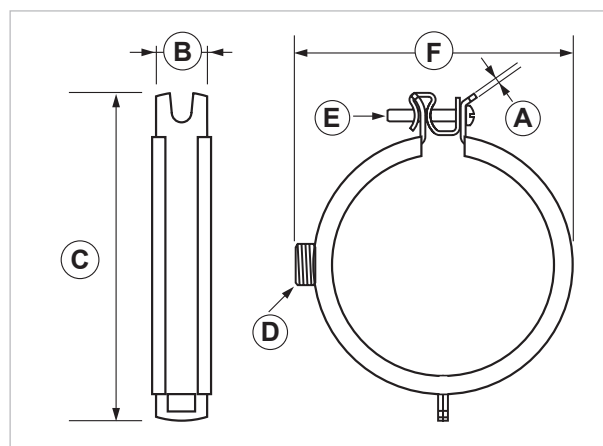
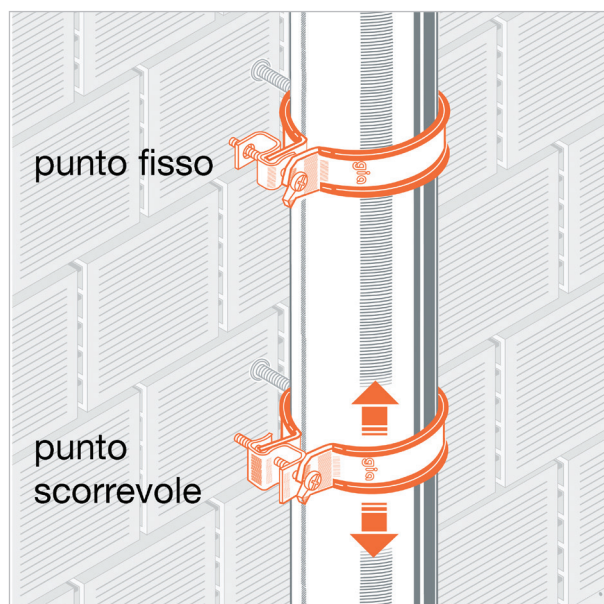

| COD    | TYPE     | For pipe lines Ø mm | A    | B  | C   | D          | E     | F   |
|--------|----------|---------------------|------|----|-----|------------|-------|-----|
| 087075 | SI 75-78 | 75-78               | 2,50 | 25 | 130 | 1/2" x M10 | M6x40 | 105 |
| 087090 | SI 90    | 90                  | 2,50 | 25 | 145 | 1/2" x M10 | M6x40 | 120 |
| 087110 | SI 110   | 110                 | 2,50 | 25 | 165 | 1/2" x M10 | M6x40 | 140 |
| 087125 | SI 125   | 125                 | 2,50 | 25 | 180 | 1/2" x M10 | M6x40 | 155 |
| 087135 | SI 135   | 135                 | 2,50 | 25 | 190 | 1/2" x M10 | M6x40 | 165 |
| 087160 | SI 160   | 160                 | 2,50 | 25 | 215 | 1/2" x M10 | M6x40 | 190 |

# INSULATED PIPE CLAMPS

## PIPE CLAMPS AND PIPE LINES FIXINGS

### ACOUSTICS IN DRAINAGE SYSTEMS

The noises produced by drainage systems are due to **pipe lines vibration**, which is generated by the fall of waste liquids which:

- Lap the walls of the vertical pipe line;
- Hit against the joints walls when changing directions;
- Flow in the horizontal pipe lines.

The noise that is spread by a drainage system can occur either by air or by structure, spreading from the pipe lines to the whole building via the fixing system.

**Therefore, the technical features of the fixing system play a major role in reducing the amount of noise in such plumbing systems.**

**SI** insulated pipe clamps are characterized by super soundproof qualities which allow them to significantly reduce the noise spread when compared to those fixings that are still built with traditional pipe clamps.

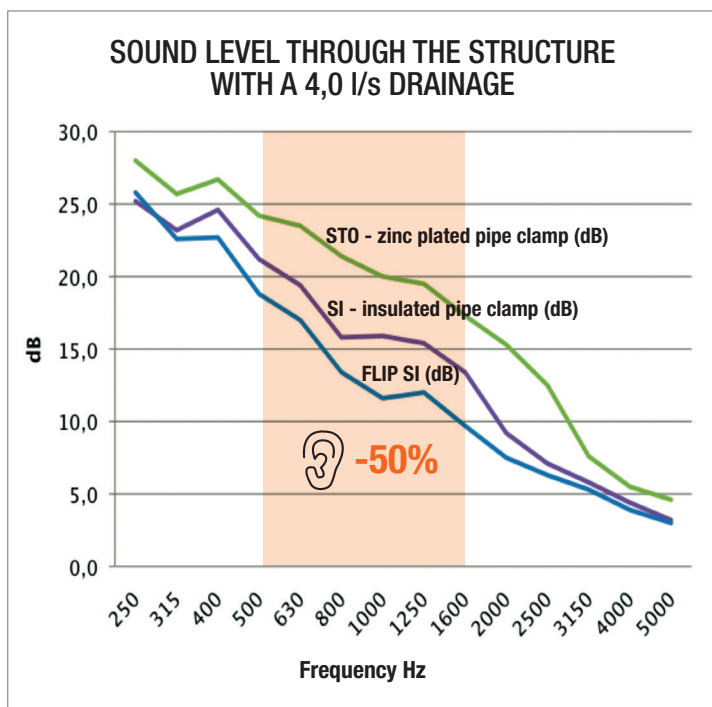
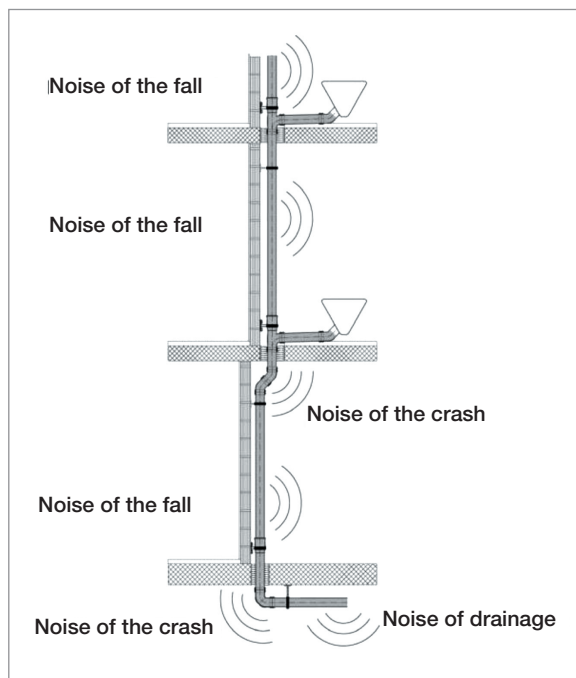

Laboratory test provided by Istituto Giordano (Gatteo, FC, Italy) to measure the amount of noise produced by waste water systems according to the UNI EN 14366:2005 regulation.

Technical reports are available on request, by texting to:

**assistenza@gia.it**

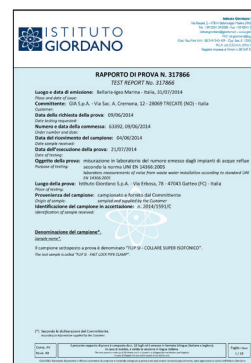

### RECOMMENDED LOADS

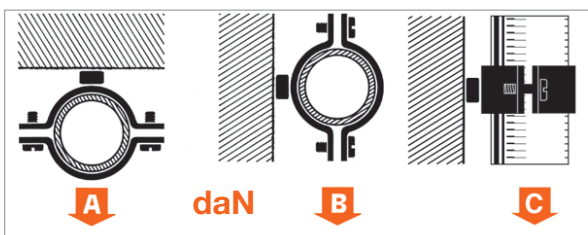

Data are expressed in daN. 1 daN=1 kg.

| TYPE     | A  | B  | C  |
|----------|----|----|----|
| SI 75-78 | 50 | 70 | 60 |
| SI 90    | 50 | 70 | 60 |
| SI 110   | 50 | 70 | 60 |
| SI 125   | 50 | 70 | 60 |
| SI 135   | 50 | 70 | 60 |
| SI 160   | 50 | 70 | 60 |

Tests were carried out in technical laboratory with a dynamo-metric machine. For wall fixing, stick to the strength characteristics of the plug or the connecting support. Recommended load is the average resistance loads with a safety coefficient.

# INSULATED PIPE CLAMPS

## PIPE CLAMPS AND PIPE LINES FIXINGS

### MATERIALA TECHNICAL DATA

#### PIPE CLAMP

Steel DD11 (material. N. 1.0332) DIN EN 10111 - with electro zinc-plating 7-8  $\mu\text{m}$

#### JOINT THREADING

1/2" male and M10 female

#### LOCKING SCREW

Steel 4.8 EN ISO 898.1 with electro zinc plating 7-8  $\mu\text{m}$   
M6x40 - Rounded head combined shear screw

#### INSULATING SHEATH

Halogen-free EPDM

#### ACOUSTIC INSULATION

Noise reduction

#### RESISTANCE TO DEGRADATION

Resistant to atmospheric agents and UV rays

#### TEMPERATURE

-35°C / + 90°C

#### HARDNESS - SHORE A

50+ / -5

#### BREAKAGE LOAD

9 MPa min.

#### CONDUCTIVITY

0,3 W/Km

#### PERFORMANCE UNDER FIRE SITUATIONS

"E" EN 13501

### PACKAGING

In cardboard box

### RELATED ITEMS

> BF - Threaded rod

### DATA 09-2022 REV. 01

The current technical data sheet substitutes and cancels the previous ones. The details provided fit our current knowledge of the product. It cannot lead us to any sort of responsibility or compensation.

Gia S.p.A. reserves the right of changing technical features and molds without notice.

This company is subject to "Ethica Global Investments S.p.A." management.

Gia S.p.A. – Via Sac. A. Cremona, 12 – 28069 Trecate (NO) – [www.gia.it](http://www.gia.it)