



Floor support cover shell

APPLICATION

Used as finishing for MP, MP1, MP2 floor supports.

FEATURES AND BENEFITS

- > It guarantees **the best aesthetic result**.
- > The rings on its body make it easy to adjust height through **cut** in order to perfectly fit the floor support.
- > It is composed of two half-shells that have to be assembled.
- > Available in two versions: **chrome plated** and **white painted**.

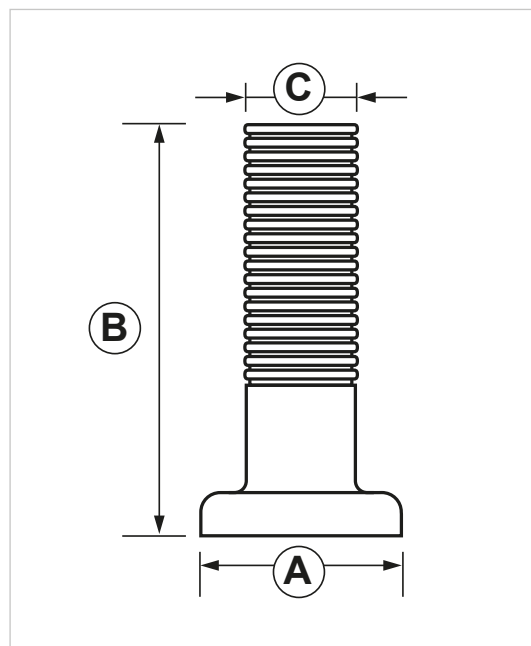
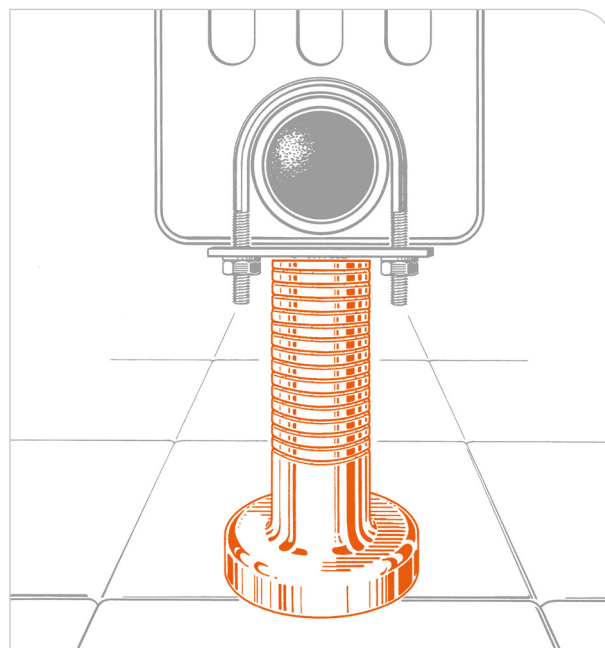

COD	TYPE	Application	Finishing	A	B	C
018010	SCO	For MP / MP1 / MP2 floor supports	chrome plated	84	175	48
018011	SCO 1	For MP / MP1 / MP2 floor supports	white	84	175	48

**MATERIAL TECHNICAL DATA****COVER SHELL**

Plastic material (ABS)

DATA 03-2020 REV. 00

The current technical data sheet substitutes and cancels the previous ones. Information correspond with our current knowledge of the product. It cannot lead us to any sort of responsibility or compensation.

Gia S.p.A. reserves the right of changing technical features and molds without notice.

Gia S.p.A. – Via Sac. A. Cremona, 12 – 28069 Trecate (NO) – www.gia.it

T 01.04.11 REV 0

