

### SBA Band support

#### APPLICATION

For hanging fixing with steel band.

#### FEATURES AND BENEFITS

- > It is used as the final fixing element on a threaded rod or else.
- > It is provided **with electro-welded nut**, and related bolt and screw.

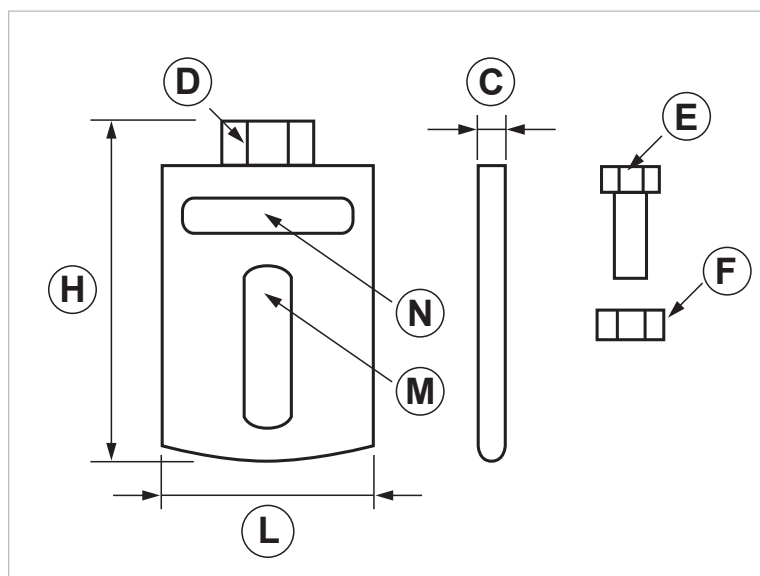
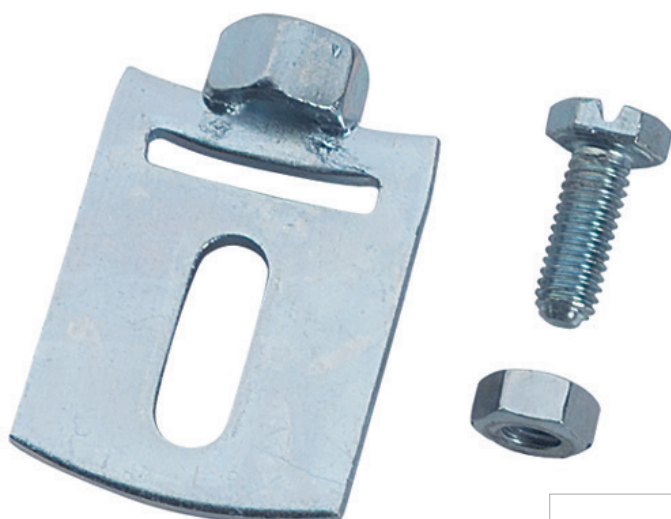
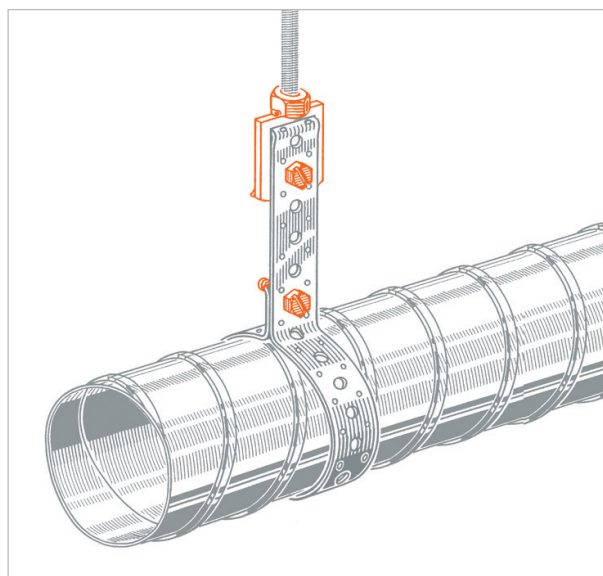

COD	TYPE	C	D	E	F	H	L	M	N
072010	SBA	3	M8	M6x20	M6	51	30	20x6,5	4x21

# FIXING'S ACCESSORIES

## PERFORATED BANDS

### MATERIALS TECHNICAL DATA

#### SUPPORT

Galvanized steel DD11 EN 10111

#### NUTS AND SCREWS

Steel 4.8 EN ISO 898.1 with electro zinc-plating 7-8 µm

### RECOMMENDED LOADS

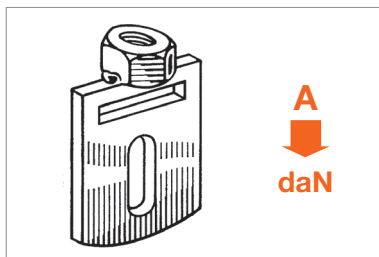

TYPE	A
SBA	60

Recommended load is the average resistance loads with a safety coefficient.  
Data expressed in daN.  
1 daN=1kg.

### PACKAGING

In transparent bags

### RELATED ITEMS

- > CC - Band fixing nail
- > BA - BA1 - Perforated steel band

### DATE 11-2022 REV. 01

The current technical data sheet substitutes and nullifies the previous ones. Information correspond with our current knowledge of the product. It cannot lead us to any sort of responsibility or compensation. Gia S.p.A. reserves the right of changing technical features and molds without previous notice. Company under the management of "Ethica Global Investments S.p.A."

Gia S.p.A. – Via Sac. A. Cremona, 12 – 28069 Trecate (NO) – [www.gia.it](http://www.gia.it)