

PFG

Insulating sheath for strut channels

APPLICATIONS

For strut channels insulation.

FEATURES AND BENEFITS

- > Used for **PF/PF1/PF7/PF2 strut channels**.
- > It is used to insulate either the support surface or the threaded rods.
- > **Thermal insulation:** in case of cold fluids, it reduces condensation.

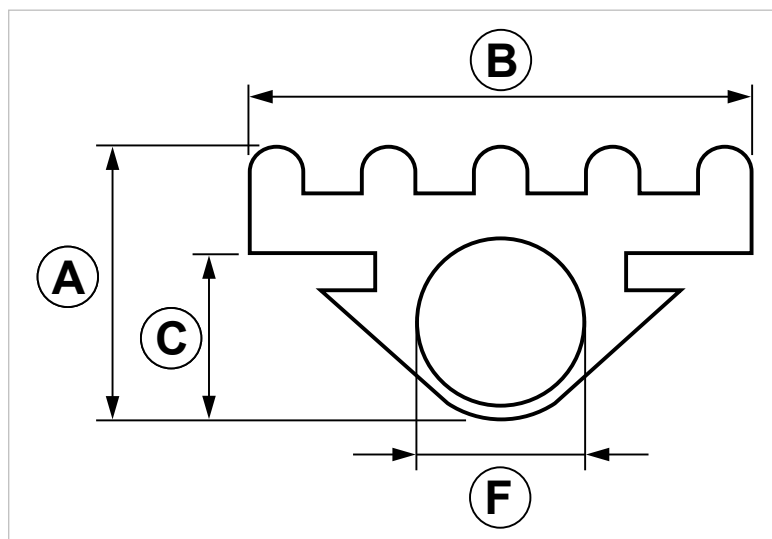
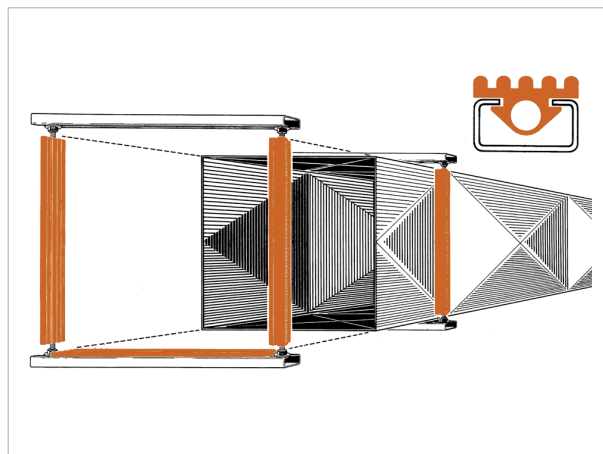

COD	TYPE	A	B	C	F
166500	PFG	18	30	9	10

GRIP LIGHT DUTY FIXING SYSTEM

CONNECTION ACCESSORIES

MATERIALS TECHNICAL DATA

SHEATH

Black EPDM rubber

HARDNESS

55 +/- 5 Shore A

TEMPERATURE

-35°C / +125°C

CONDUCTIVITY

0,3 W/Km

FIRE RESISTANCE

E EN 13501

PACKAGING

In cardboard box

RELATED ITEMS

> Strut channels

DATE 06-2023 REV. 01

The current technical data sheet substitutes and cancels the previous ones. The details provided fit our current knowledge of the product. It cannot lead us to any sort of responsibility or compensation.

Gia S.p.A. reserves the right of changing technical features and molds without notice.

This company is subject to "Ethica Global Investments S.p.A." management.

Gia S.p.A. – Via Sac. A. Cremona, 12 – 28069 Trecate (NO) – www.gia.it