

PA 30 GRIP

Grip cantilever arm bracket

APPLICATION

Pipe lines fastening on wall, ceiling or floor.

FEATURES AND BENEFITS

- > The **patented knurling** applied to the rail sides - both inside and outside - prevents connection parts from sliding.
- > It is made of **PF1 grip strut channel**.

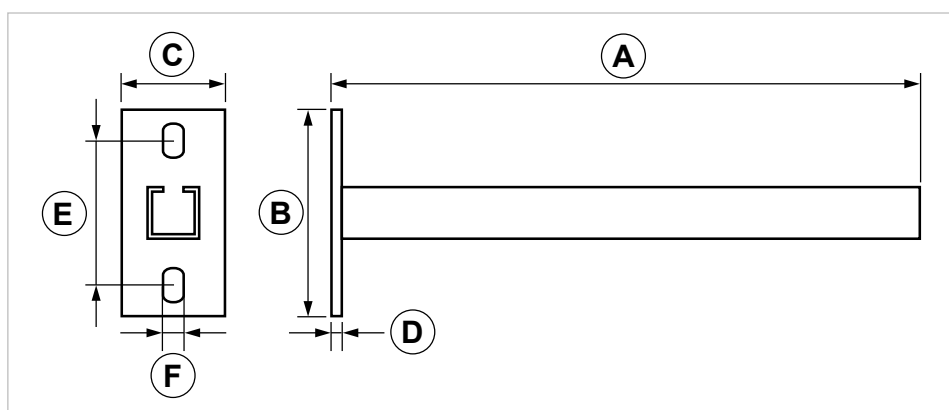
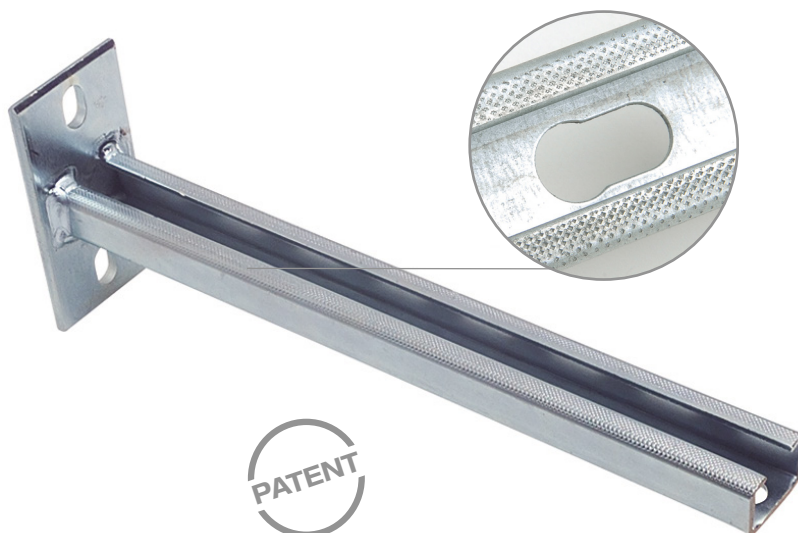
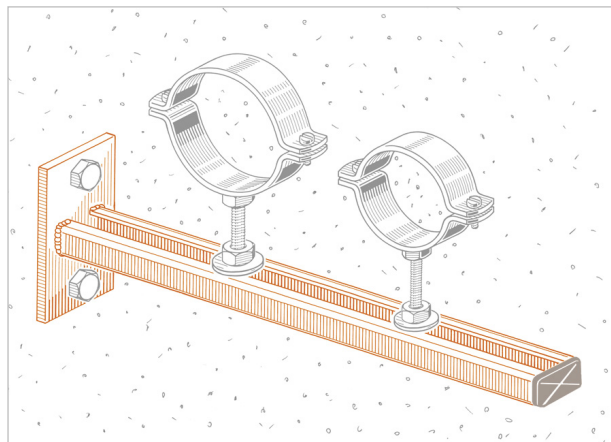

COD	TYPE	Finishing	Strut channel	A	B	C	D	E	F
161220	PA 30 GRIP	Galvanized	PF1 Grip	285	100	50	5	70	10x16,5

GRIP LIGHT DUTY FIXING SYSTEM



SUPPORTING BRACKETS

MATERIALS TECHNICAL DATA

BRACKET

Carbon steel DX51 DZ200 EN 10142 with sendzimir plating

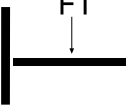
RECOMMENDED LOADS

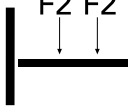
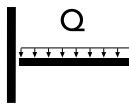
TYPE	 F1 = daN	 F1 = daN	 F2 = daN	 Q = daN
PA 30 GRIP	75	37	40	75

F = concentrated load in daN. - Q = uniform load in daN.
 Admissible tension 140 N/mm2. - Admissible deflection L/125.
 For wall fastening please consider the supporting performance of the plug or the connection piece.

PACKAGING

In cardboard box

RELATED ITEMS

- > Pipe clamps
- > BF - Threaded rod

DATE 06-2023 REV. 01

The current technical data sheet substitutes and cancels the previous ones. The details provided fit our current knowledge of the product. It cannot lead us to any sort of responsibility or compensation.
 Gia S.p.A. reserves the right of changing technical features and molds without notice.
 This company is subject to “Ethica Global Investments S.p.A.” management.

Gia S.p.A. – Via Sac. A. Cremona, 12 – 28069 Trecate (NO) – www.gia.it