



## PA40 GRIP cantilever arm bracket



### APPLICATIONS

Pipe lines fastening on wall, ceiling or floor.

### FEATURES AND BENEFITS

- > The **patented knurling** applied to the rail sides - both inside and outside - prevents connection parts from sliding.
- > Thanks to the **rectangular loops** it is possible to insert connection items even during installation.
- > It is made of **PF2 grip strut channel**.

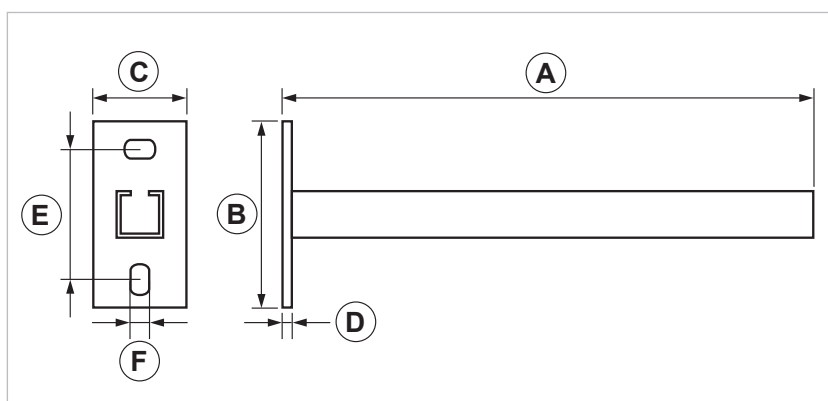
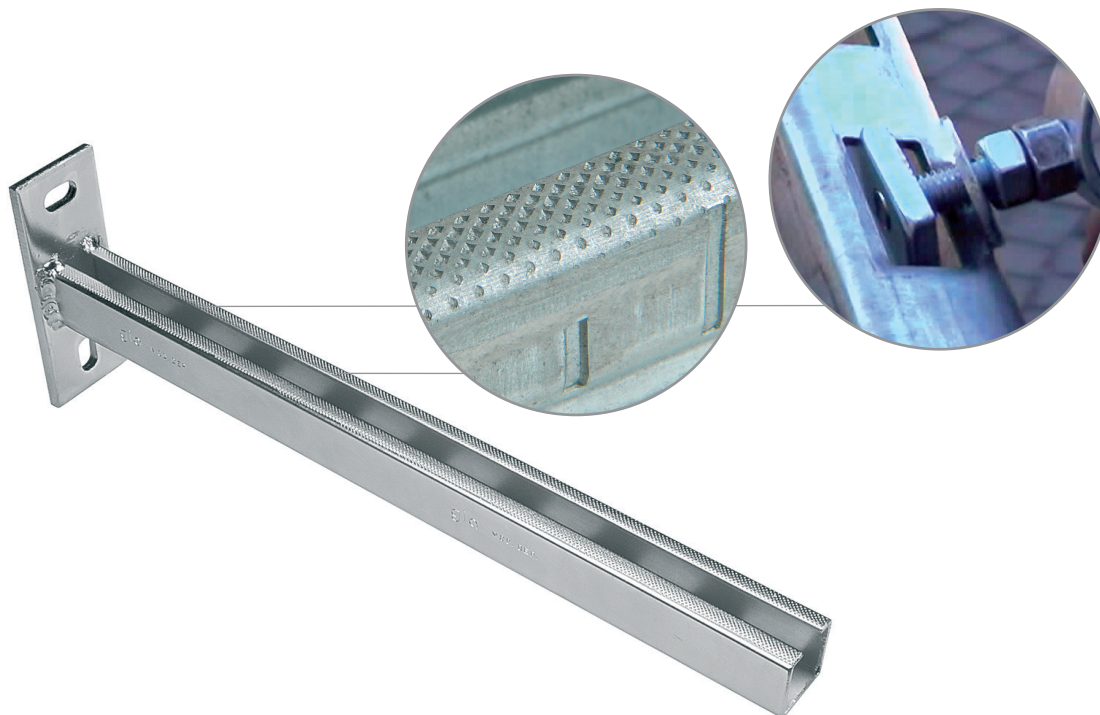
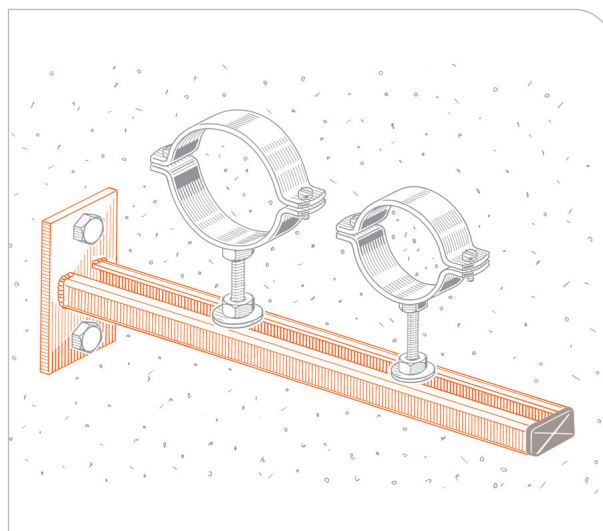

COD	TYPE	Finishing	Strut channel	A	B	C	D	E	F
161225	PA 40 GRIP	Zinc plating	PF2 grip	400	130	50	6	95	10,5 x 20





## MATERIALS TECHNICAL DATA

### MATERIAL

Steel DD11 EN 10111 with electro zinc plating 7-8  $\mu\text{m}$

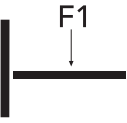
### RECOMMENDED LOADS

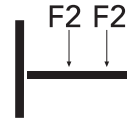
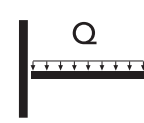
TYPE				
	<b>F1 = daN</b>	<b>F1 = daN</b>	<b>F2 = daN</b>	<b>Q = daN</b>
PA 40 grip	110	50	55	110

**F** = concentrated load in daN. - **Q** = uniform load in daN.

Admissible tension 140 N/mm<sup>2</sup>. - Admissible deflection L/125.

The values in the chart above show payloads with perfect springback.

For wall fastening please consider the plug's or the connection's supporting performance. Values expressed in daN.

### PACKAGING

In cardboard box

### RELATED ITEMS

- > Threaded rods
- > Pipe clamps

### DATE 09-2021 REV. 00

The current technical data sheet substitutes and cancels the previous ones. Information correspond with our current knowledge of the product. It cannot lead us to any sort of responsibility or compensation.

Gia S.p.A. reserves the right of changing technical features and molds without notice.

Gia S.p.A. – Via Sac. A. Cremona, 12 – 28069 Trecate (NO) – [www.gia.it](http://www.gia.it)

