

### Cast iron and tubular radiators bevelled telescopic bracket

#### APPLICATION

Cast iron and tubular radiator fastening.

#### FEATURES AND BENEFITS

- > It makes radiators installation on wall **faster and easier**.
- > It ensures a **pinpoint adjustment** of the radiator's distance from the wall.
- > The **best aesthetic result** is guaranteed by the exclusive bevelled tip.
- > Smooth bracket and **telescopic adjustment**.
- > Carbon steel bracket provided with flexible anchor and covering washer (detached from the anchor). **Available either white zinc-plated or white painted (RAL 9003).**

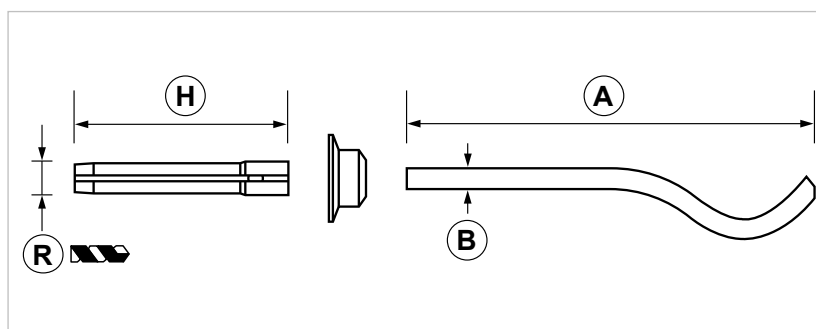
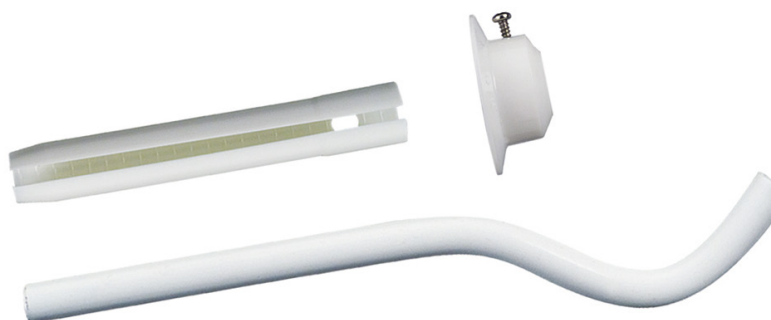
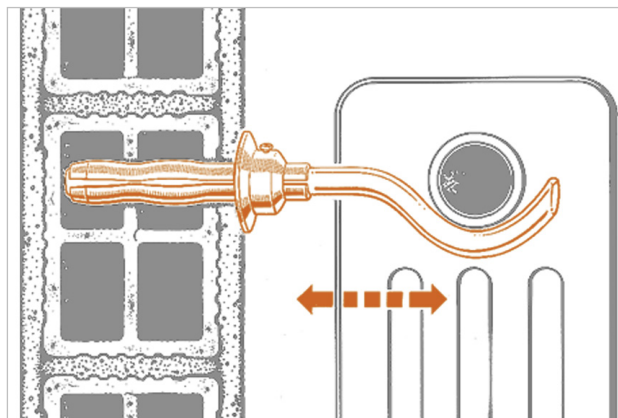

COD	TYPE	Application	Finishing	A	B	H	R	Notes
010101	L2 BIANCA	more than 6 columns	white painted	332	12	111	15	*
010000	L	5 / 6 columns	galvanized	254	12	111	15	
010001	L BIANCA	5 / 6 columns	white painted	254	12	111	15	
011000	M	4 columns	galvanized	223	12	111	15	
011001	M BIANCA	4 columns	white painted	223	12	111	15	
012000	C	3 columns	galvanized	201	12	111	15	
012001	C BIANCA	3 columns	white painted	201	12	111	15	

\* Version without bevelled tip.

# TELESCOPIC BRACKETS

## RADIATORS FIXINGS

### MATERIALS TECHNICAL DATA

#### BRACKET

Carbon steel S235JR - EN10027

#### PLUG AND COVERING WASHER

PE White polyethylene

#### BASE MATERIAL

Masonry - Plastered hollow brick - Concrete

### RECOMMENDED LOADS

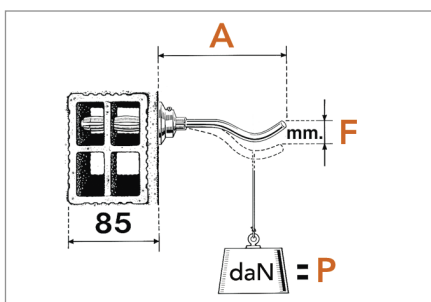

	A	F	P
L2	235	3,5	20
L	170	3,5	40
M	150	3,5	70
C	126	3,5	100

Recommended loads refer to the single bracket. The payload defines the metal bracket capacity, not the wall one.

Recommended load is the average load capacity with a safety coefficient.

1 daN=1 kg.

### INSTALLATION

In order to properly install the plug, make a hole perpendicularly to the base support using the right drill bit. Before applying the plug, the hole must be cleaned up and the drilling dust removed. We recommend not to use an impact drill to make the hole on an hollow bricks wall in order to prevent internal bulkheads breakage. Insert the plug and then the bracket by using a hammer.

Add the covering washer and adjust the bracket. Fix the bracket by screwing the screw set in the washer. Eventually, install the radiator checking it is properly adjusted.

### INSTALLATION TOOLS AND RECOMMENDATIONS

Drill with appropriate drill bit.

Do not use impact drill in order to prevent internal bulkheads breakage.

### PACKAGING

In polyethylene bags - Pair of brackets

### RELATED ITEMS

- > Universal jig for radiator connections
- > Spare plug for radiator brackets

### DATE 05-2022 REV. 00

The current technical data sheet substitutes and nullifies the previous ones. Information correspond with our current knowledge of the product. It cannot lead us to any sort of responsibility or compensation.

Gia S.p.A. reserves the right of changing techical features and molds without previous notice.

Gia S.p.A. – Via Sac. A. Cremona, 12 – 28069 Trecate (NO) – [www.gia.it](http://www.gia.it)