

ISO 8

Medium duty fixing for insulated walls

APPLICATION

Fixing on walls with insulating panels up to 100 mm thick.

FEATURES AND BENEFITS

- > The use of several components **increases thermal insulation**.
- > The 35mm long ending joint **is shaped in order to simplify the item's insertion into the insulating panel** with M6 and M8 threads.
- > **Complete with cover washer** to guarantee the thermal closure of the hole.
- > The Giolli plug guarantees a **reliable and strong grip** on any kind of wall. Install it by using the so called "PTN 10" inserting tool (cod. 120010).

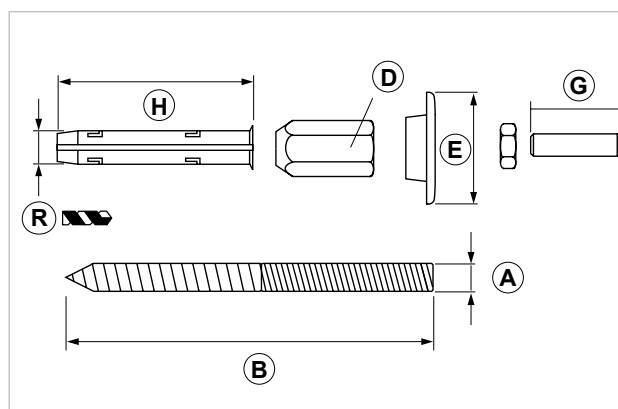
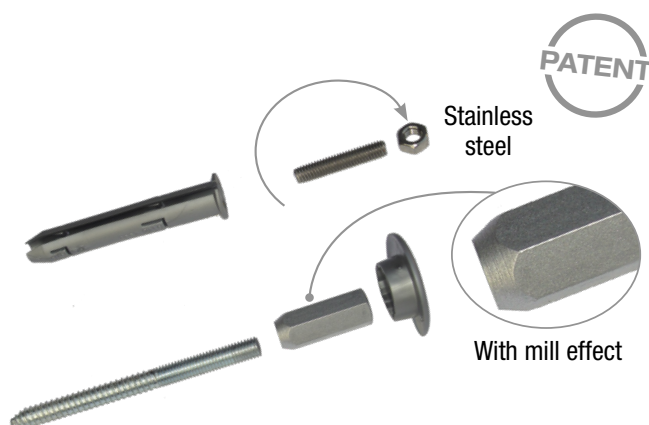
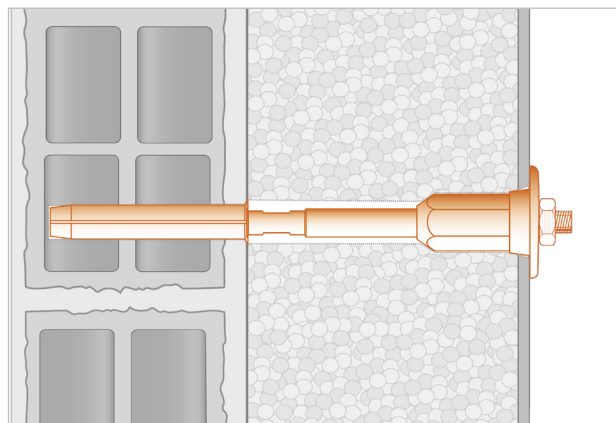

COD	TYPE	For insulated walls (mm)	Min. hole depth (mm)	A	B	D	E	G	H	R
120050	ISO 8X100	40 -65	140	M8	100	sw 13	27	32	70	10
120055	ISO 8X140	80 - 105	180	M8	140	sw 13	27	32	70	10

RECOMMENDED LOADS

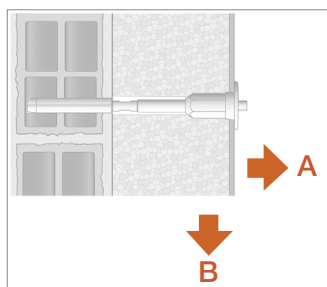

TYPE	Insulating panel thickness	A				B
		Hollow brick	Solid brick	Concrete	Cellular concrete	
ISO 8X100	60 mm	50	100	150	13	15
ISO 8X140	100 mm	50	100	150	13	10

Recommended load is the average resistance loads with a safety coefficient. Data in daN - 1daN=1kg.

ANCHORS AND SEALANTS

ANCHORS FOR INSULATED WALLS

MATERIALS TECHNICAL DATA

SCREW AND JOINT = Steel 4.8 EN ISO 898-1 with electro zinc plating 7-8 µm

PLUG = PP Polypropylene

COVER WASHER = PP Polypropylene

THREADED STUDS AND NUT = Stainless steel AISI 304 - EN 10088

BASE MATERIAL

Solid masonry - Aerated cellular concrete (Gasbeton) - Hollow brick walls - Cement - Prestressed concrete

INSTALLATION PROCESS

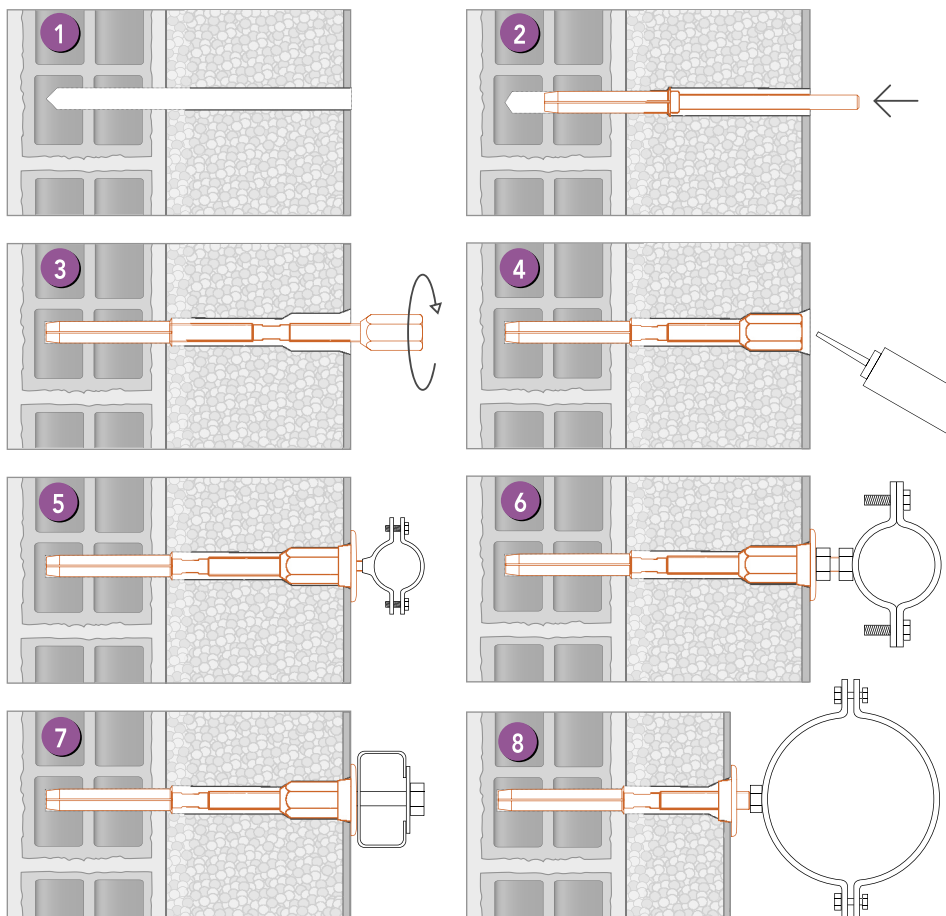

WITH ISO 8 AND ISO 10

- 1- Drill insulating panel and wall with a drill bit of:
Ø 10 for ISO 8
Ø 12 for ISO 10
- 2- Insert TN plug using PTN inserting tool
- 3- Tighten the screw either with or without the reduction piece
- 4- Set screw and joint flush the insulating panel and seal the borders. Apply the insulating washer and the covering finish.
- 5- Fasten the product on the external wall using the M6 stud.

MOREOVER WITH ISO 10

- 6- Fasten the product on the external wall using the M8 stud
- 7- It is possible to install it with a bolt
- 8- It is possible to install it with M10

INSTALLATION TOOLS AND RECOMMENDATIONS

Drill with proper drill bit.

Do not use the impact drill to prevent breaking the internal bulkhead of the brick.

PACKAGING

In polyethylene bags

DATE 06-2023 REV. 01

The current technical data sheet substitutes and cancels the previous ones. The details provided fit our current knowledge of the product. It cannot lead us to any sort of responsibility or compensation.

Gia S.p.A. reserves the right of changing technical features and molds without notice.

This company is subject to "Ethica Global Investments S.p.A." management.

Gia S.p.A. – Via Sac. A. Cremona, 12 – 28069 Trecate (NO) – www.gia.it