



CLIPPO - EPDM rubber hinged pipe clamp

APPLICATION

Suitable for fixing pipe lines that are to be insulated up to 2" size.

FEATURES AND BENEFITS

- > The **clip locking system** speeds up the tightening of the pipe so that you just have to tighten the preassembled screw.
- > The black EPDM rubber ensures further **insulation uniformity around the whole pipe circumference** and the reduction of the noise that is transmitted by the pipe to the support.
- > **Handy**: it is made of two light duty half-pipe clamps - made of galvanized steel with an electro-welded nut and hinged together - that are completed with a black EPDM rubber strip and a pre-assembled coupling system.

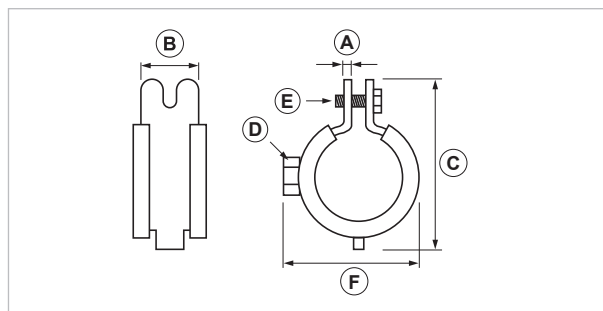
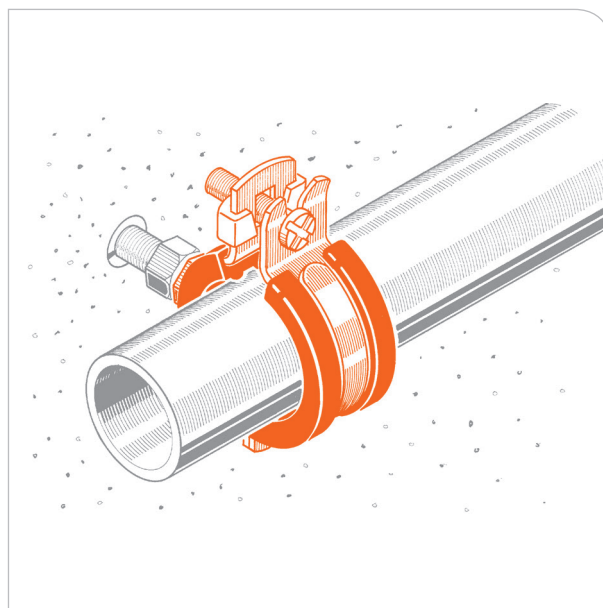

COD	TYPE	For pipe lines Ø mm	A	B	C	D	E	F
081000	CLIPPO 1/4"	12 - 14	1,5	20	45	M8	M5x25	34
081010	CLIPPO 3/8"	15 - 18	1,5	20	50	M8	M5x25	39
081020	CLIPPO 1/2"	20 - 23	1,5	20	54	M8	M5x25	45
081030	CLIPPO 3/4"	25 - 28	1,5	20	58	M8	M5x25	50
081040	CLIPPO 1"	32 - 35	1,5	20	66	M8	M5x25	57
081050	CLIPPO 1 1/4"	40 - 43	1,5	20	73	M8	M5x25	64
081060	CLIPPO 1 1/2"	48 - 50	1,5	20	81	M8	M5x25	71
081070	CLIPPO 54	50 - 54	1,5	20	96	M8	M5x25	86
081080	CLIPPO 2"	60 - 63	1,5	20	96	M8	M5x25	86



MATERIAL TECHNICAL DATA

MATERIAL

Steel DD11 (material. N. 1.0332) DIN EN 10111

GALVANIZATION

Electro zinc-plating 7-8 µm

CONNECTING THREAD

M8

LOCKING SCREW

Steel 4.8 EN ISO 898.1 with electro zinc-plating 7-8 µm
Hex head combined shear screw

SHEATH

Halogen free EPDM rubber

ACOUSTIC INSULATION

Noise reduction

TEMPERATURE

- 35°C / + 125°C

HARDNESS - SHORE A

55+ / -5

BREAKAGE LOAD

5 MPa min.

CONDUCTIVITY

0,3 W/Km

FIRE RESISTANCE

“E” EN 13501class



RECOMMENDED LOADS

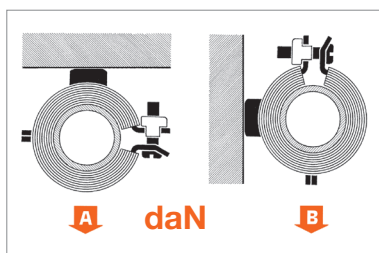

TYPE	A	B
CLIPPO 1/4"	70	60
CLIPPO - CLIPPO S 3/8"	70	60
CLIPPO - CLIPPO S 1/2"	70	60
CLIPPO - CLIPPO S 3/4"	70	60
CLIPPO - CLIPPO S 1"	70	60
CLIPPO - CLIPPO S 1 1/4"	70	60
CLIPPO - CLIPPO S 1 1/2"	70	60
CLIPPO 54	70	60
CLIPPO - CLIPPO S 2"	70	60

Tests were carried out in technical laboratory with a dynamometric machine. For wall fixing, stick to the strenght characteristics of the plug or the connecting support.

Recommended load is the average resistance loads with a safety coefficient.

Data in daN. 1 daN=1 kg.

PACKAGING

Cardboard box

**DATE 03-2019 REV. 00**

The current technical data sheet substitutes and cancels the previous ones. Information correspond with our current knowledge of the product. It cannot lead us to any sort of responsibility or compensation.

Gia S.p.A. reserves the right of changing technical features and molds without notice.

Gia S.p.A. – Via Sac. A. Cremona, 12 – 28069 Trecate (NO) – www.gia.it

T 03.15.71 REV 0

