

## BFT Threaded pipe

### APPLICATION

Used as extensions or to directly connect pipe clamps and wall fixing plates.

### FEATURES AND BENEFITS

- > Thanks to its 1/2" BSP thread, it is particularly **versatile and suitable** for different joints and pipe clamps.
- > The tubular section makes it **light and handy**, yet at the same time it guarantees a much **stronger fastening** as compared with the one obtained by using a threaded rod.
- > It is not approved for drinkable water.

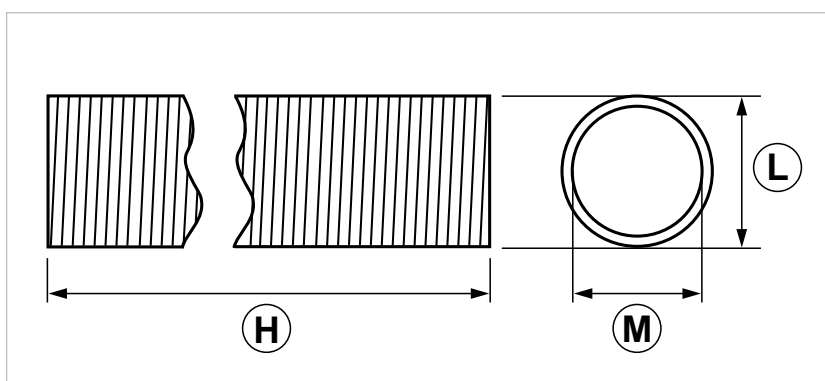
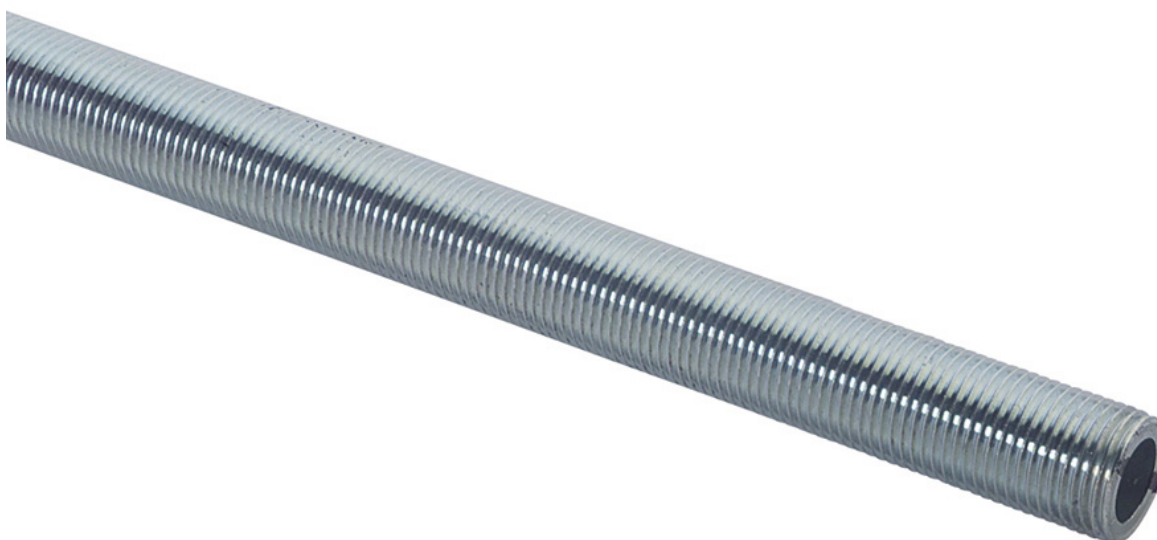
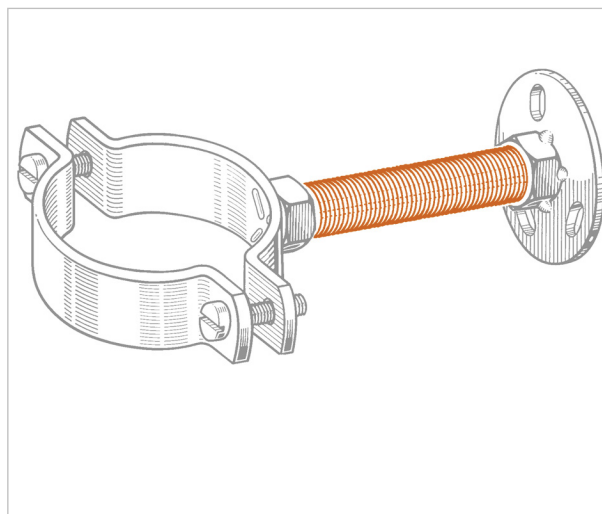

COD	TYPE	H	L	M
266000	BFT 1/2"	1000	G 1/2"	13,5

# FIXING'S ACCESSORIES

## HANGING SUPPORTS

### MATERIALS TECHNICAL DATA

#### MATERIAL

Galvanized steel Fe33 EN 10027

#### RECOMMENDED LOADS

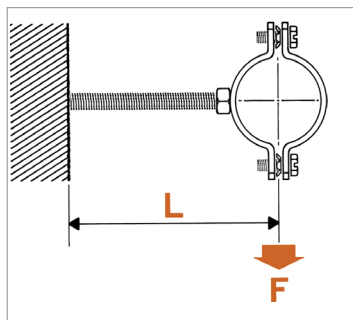

TYPE	50 mm	100 mm	150 mm	200 mm	250 mm	300 mm
BFT 1/2	240	120	80	60	40	20

Recommended load is the average resistance loads with a safety coefficient.

Data provided in daN. 1 daN=1 kg

$F = daN$

Recommended strength =  $f_{max} = 3 \text{ mm}$

Affordable stress=  $\delta_{am} = 16 \text{ daN/mm}^2$ .

#### PACKAGING

Provided in bundle.

#### DATE 11-2022 REV. 01

The current technical data sheet substitutes and nullifies the previous ones. Information correspond with our current knowledge of the product. It cannot lead us to any sort of responsibility or compensation.

Gia S.p.A. reserves the right of changing techical features and molds without previous notice.

Company under the management of "Ethica Global Investments S.p.A."

Gia S.p.A. – Via Sac. A. Cremona, 12 – 28069 Trecate (NO) – [www.gia.it](http://www.gia.it)