

ANS 90 3D 3D quick connection angle fitting

APPLICATION

It is used to set up brackets and supporting structures without welding.

FEATURES AND BENEFITS

- > The exclusive shape of the loops - designed to fit the so called "JBR 10" bolt (cod. 161950) - makes **connection to the strut channel fast and easy**.
- > It is used to set up **3-way structures** with PF3 and PF4 strut channels.
- > Its 3-direction shape - together with the loops set on each side of the item - helps **to guide the strut channel's cavity** in the desired position during installation.

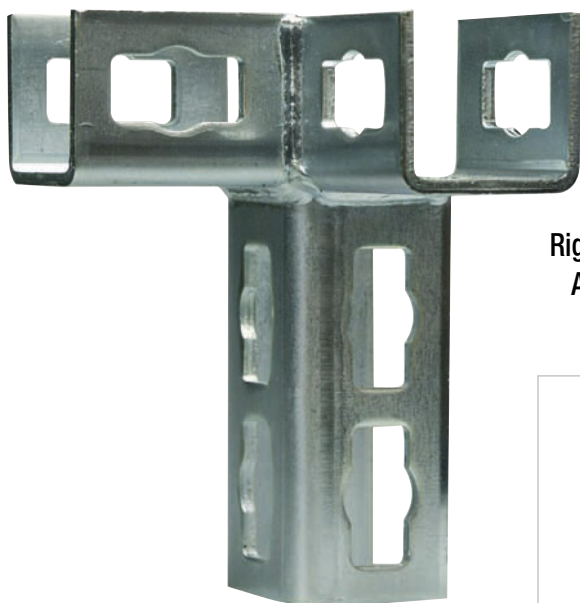
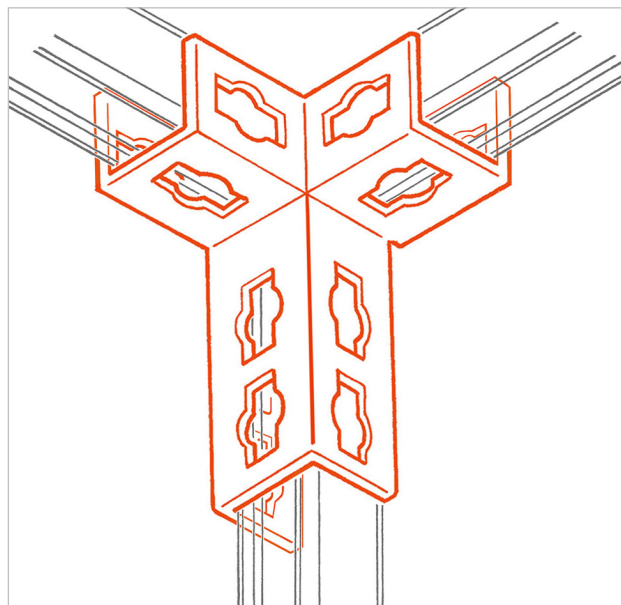

Right angle fitting
ANS 90 3D Dx

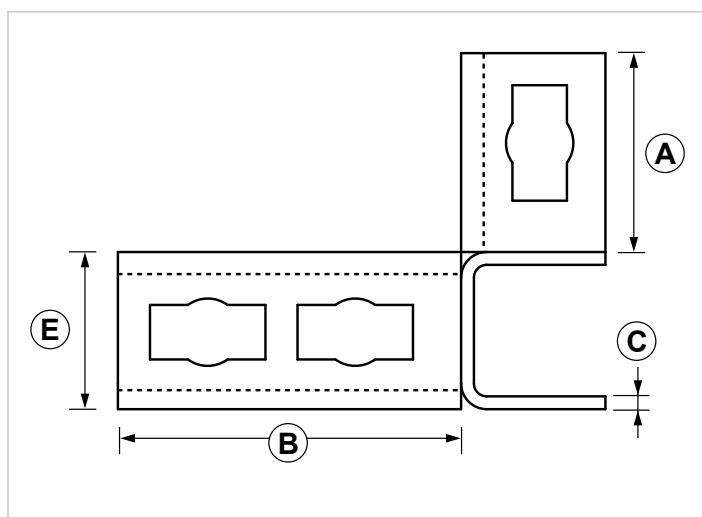

COD	TYPE	Description	A	B	C	E
161040	ANS 90 3D Sx	Left	62	107	4	52
161044	ANS 90 3D Dx	Right	62	107	4	52

INDUSTRIAL FIXING SYSTEMS

ANGLE BRACKETS AND FITTINGS FOR HEAVY DUTY STRUT CHANNELS

MATERIALS TECHNICAL DATA

ANGLE FITTING

Steel DD11 EN 10111 with electro zinc-plating 7-8 µm EN ISO 12329

RECOMMENDED LOADS

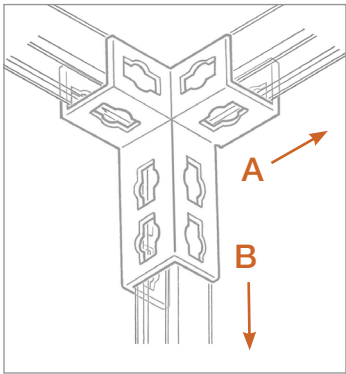

TYPE	A	B
ANS 90 3D Sx	300	500
ANS 90 3D Dx	300	500

Recommended load is the average resistance load with a safety coefficient.
1 daN=1 kg.

PACKAGING

In cardboard box

RELATED ITEMS

- > PF3 and PF4 strut channels
- > JBR 10 - Quick connection bolt

DATE 07-2023 REV. 01

The current technical data sheet substitutes and cancels the previous ones. The details provided fit our current knowledge of the product. It cannot lead us to any sort of responsibility or compensation.

Gia S.p.A. reserves the right of changing technical features and molds without notice.

This company is subject to "Ethica Global Investments S.p.A." management.

Gia S.p.A. – Via Sac. A. Cremona, 12 – 28069 Trecate (NO) – www.gia.it